

Positions of cable direction

exemplary: Position 0

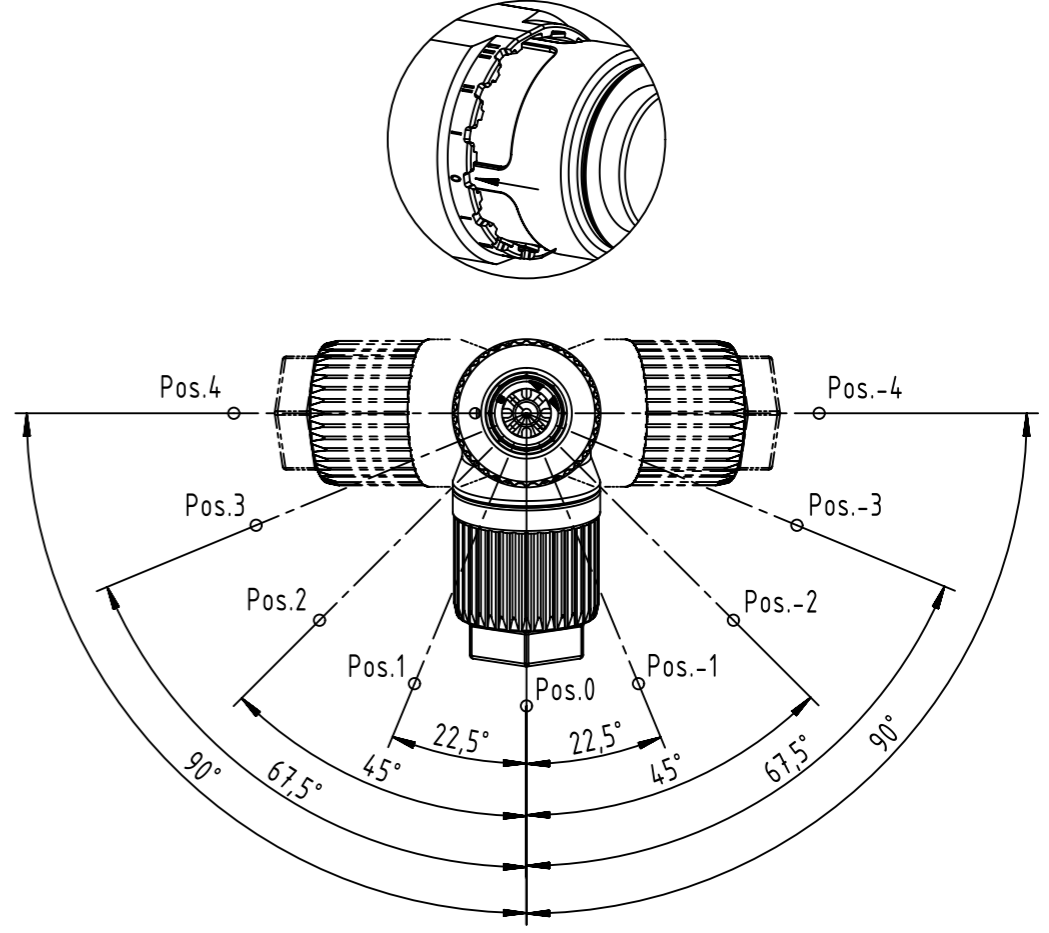

A (2:1)

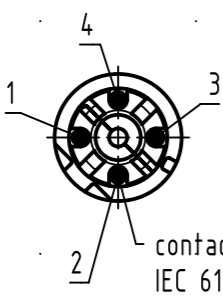

contact face acc. to IEC 61076-2-101

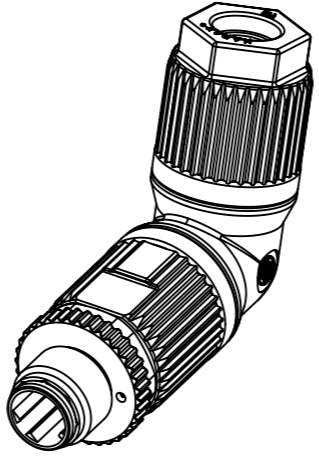

order contacts separately

cable	wire gauge		part-no.
4.5-8.8mm	0.25-0.50mm <sup>2</sup>	AWG 24-20	09 67 000 8576
	0.14-0.34mm <sup>2</sup>	AWG 26-22	09 67 000 5576
	0.34-0.75mm <sup>2</sup>	AWG 22-18	09 67 000 3576

	All Dimensions in mm Original Size DIN A3		Scale 1:1	Free size tol.		Ref.	
	All rights reserved Department EC PD - DE		Created by DYCKC	Inspected by EISFELD	Standardisation HOFFMANN	Date 2017-04-04	State Final Release
HARTING Electronics GmbH D-32339 Espelkamp		Title HARTING M12 angled male 4-pole D-coded crimp				Doc-Key / ECM-Nr. 100518241/UGD/004/G 500000117709	
		Type TB	Number 21038823405			Rev. G	Page 1/1