

DO NOT SCALE FROM THIS PRINT

BTH-XXX-XX-X-D-XX

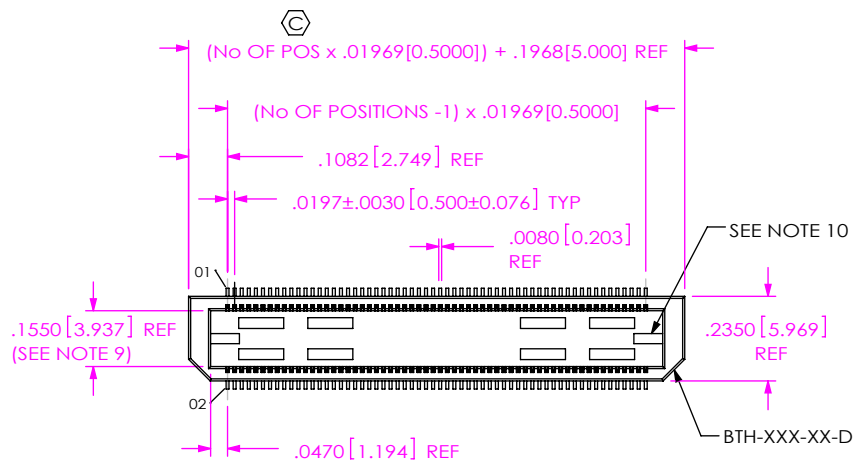

No. OF POSITIONS
 030, ***050, 060, 090,
 *120, *150
 (PER ROW)
 LEAD STYLE -02 ONLY: 030 - 150
 MULTIPLES OF 10

OPTION

- A: ALIGNMENT PINS
 (USE BTH-XXX-XX-D-A FOR STYLES -01 & -02) (FOR STYLES -03 THRU -09, SEE TABLE 4 & FIG 4, SHEET 3)
- LC: LOCKING CLIPS (SEE NOTE 8)
 (USE LC-08-TM-01)
- K: POLYIMIDE FILM
 (USE K-DOT-.276-.375-.005, SEE FIG 2)
 (AVAILABLE ON STYLES -01 THRU -04 & -09 ONLY)
- TR: TAPE & REEL (120 POS MAX)
 [N/A ON -05 THRU -06] (SEE NOTE 12)
- FR: FULL REEL QTY. TAPE & REEL (120 POS MAX)
 [N/A ON -05 THRU -06] (SEE NOTE 13)

LEAD STYLE

- 01: .1680[4.267]
- 02: .2861[7.264]
 (030 -150 POSITIONS AVAILABLE)
- 03: .4042[10.267]
- 04: .6000[15.240]
- 05: .7180[18.237]
- 06: .8360[21.234]
- 09: .5224[13.269]

ROW SPECIFICATION

- D: DOUBLE (USE BTH-XXX-XX-D & BTHH-XXX-XX-D)

PLATING SPECIFICATION

- F: 3μ" SELECTIVE GOLD IN CONTACT AREA, MATTE TIN ON TAIL
- L: 10μ" SELECTIVE GOLD IN CONTACT AREA, MATTE TIN ON TAIL
- H: 30μ" GOLD IN CONTACT AREA, 3μ" GOLD ON TAIL
- C: 50μ" GOLD IN CONTACT AREA, MATTE TIN ON TAIL

*** = 50 POS. ONLY AVAILABLE FOR -01 AND -02 LEAD STYLE (REF ASP-65267-02), NOT TOOLED FOR -03 LEAD STYLE

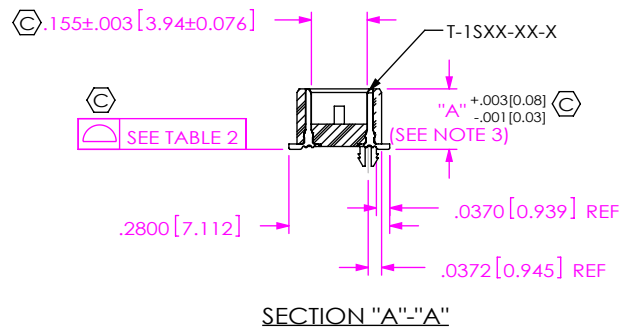
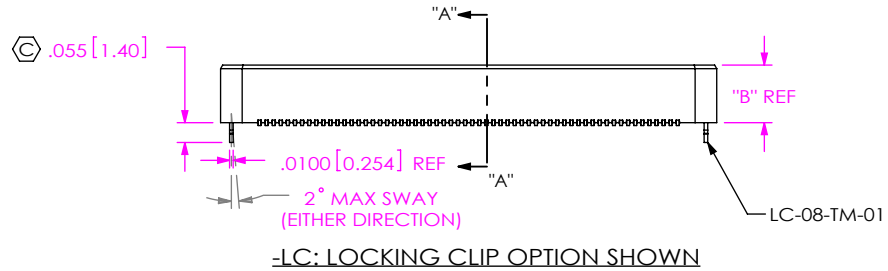

TABLE 2

NO. OF POSITIONS	COPLANARITY
-030 THRU -090	.004[.10]
-120 THRU -150	.006[.15]

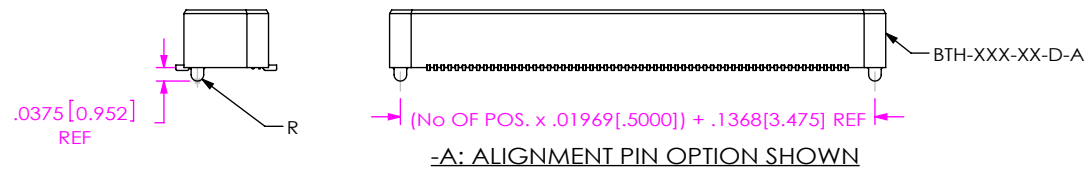
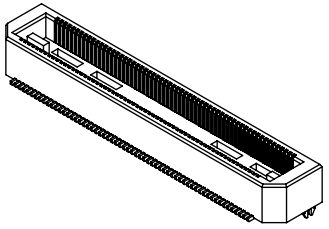

TABLE 1

STYLE	"A"	"B"	BODY	TERMINAL	MATED HEIGHT WITH BSH
-01	.1680[4.267]	.1600[4.064]	BTH-XXX-01-D(-A)	T-1S39-01-X	.1969[5.001] REF
-02	.2861[7.267]	.2781[7.064]	BTH-XXX-02-D(-A)	T-1S59-02-X	.3150[8.001] REF

- NOTES:
- ⊕ REPRESENTS A CRITICAL DIMENSION.
 - MINIMUM PUSHOUT FORCE: 6 OZ FOR STYLES -01 & -02
 8 OZ FOR STYLES -03 THRU -09
 - MAXIMUM VARIANCE: .002[0.05]
 - LEAD STYLES -03 THRU -09: TOP BODY (BTH) CANNOT HAVE -A OPTION.
 - L PLATING CAN BE SUBSTITUTED FOR -F PLATING.
 - NOTE DELETED.
 - FOR NEW APPLICATIONS REQUIRING THESE POSITIONS, PLEASE CONTACT SAMTEC INTERCONNECT PROCESSING GROUP.
 - DUE TO THE HIGH AMOUNT OF INSERTION FORCE NEEDED, THE -LC OPTION IS NOT COMPATIBLE WITH AUTO PLACEMENT. SAMTEC RECOMMENDS MANUAL PLACEMENT FOR ALL ASSEMBLIES WITH THE -LC OPTION.
 - PIN CAN EXTEND PAST THE WALL: .003 [0.08].
 - FEATURE PRESENT ONLY ON -01 LEAD STYLE.
 - GATE PAD PRESENT ON BTH-XXX-02-D-X ONLY.
 - TR OPTION ORDERS INVOLVING PARTIAL REEL QUANTITIES MAY BE PACKAGED ACCORDING TO THE SAMTEC PACKAGING EFFICIENCY STANDARDS (SPES) FOUND ON WWW.SAMTEC.COM.
 - FR OPTIONS WILL BE SHIPPED AT THE MAX QUANTITY PER REEL, BASED ON OPTIONS SELECTED.



UNLESS OTHERWISE SPECIFIED, DIMENSIONS ARE IN INCHES.
 TOLERANCES ARE:
 DECIMALS .XX: ±.01[0.3]
 .XXX: ±.005[0.13]
 .XXXX: ±.0020[0.051]

PROPRIETARY NOTE
 THIS DOCUMENT CONTAINS CONFIDENTIAL AND PROPRIETARY INFORMATION AND ALL DESIGN, MANUFACTURING, REPRODUCTION, USE, PATENT RIGHTS AND SALES RIGHTS ARE EXPRESSLY RESERVED BY SAMTEC, INC. THIS DOCUMENT SHALL NOT BE DISCLOSED, IN WHOLE OR PART, TO ANY UNAUTHORIZED PERSON OR ENTITY NOR REPRODUCED, TRANSFERRED OR INCORPORATED IN ANY OTHER PROJECT IN ANY MANNER WITHOUT THE EXPRESS WRITTEN CONSENT OF SAMTEC, INC.

INSULATOR: BLACK LCP
 FLAMMABILITY RATING: UL 94V-0

TERMINAL: PHOS BRONZE

DO NOT SCALE DRAWING SHEET SCALE: 1.875:1

DESCRIPTION:
 .5mm DOUBLE ROW TERMINAL ASSEMBLY

DWG. NO. **BTH-XXX-XX-X-D-XX**

BY: DEAN P 5/28/1999 SHEET 1 OF 3

F:\DWG\MISC\MKTG\BTH-XXX-XX-X-D-XX-MKT.SLDDRW



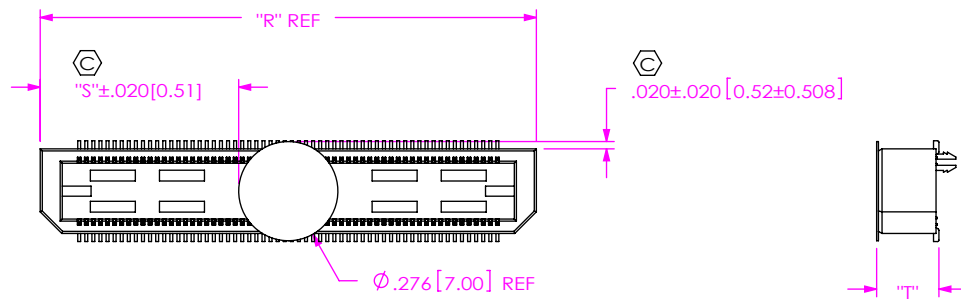
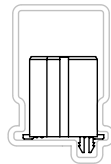

TABLE 3	
STYLE	"T"
-01	.173[4.39]
-02	.291[7.39]
-03	.409[10.39]
-04	.605[15.37]
-09	.527[13.39]

NOTE: "R" = (No OF POSITIONS x .01969[0.5000]) + .1968[5.000]
 "S" = (("R" - .276[7.01]) / 2) ±.020[0.51]

FIG 2
 -K: POLYIMIDE FILM PAD OPTION

[STYLES -01 & -02]



TUBE: PT-1-24-01-78
 PLUG: TP-03

[STYLES -03, -04, & -09]

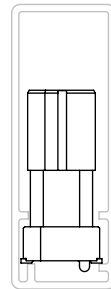

TUBE: PT-1-24-01-98
 PLUG: TP-26

[STYLE -05]

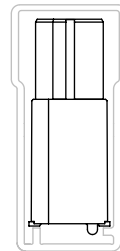

TUBE: PT-1-24-02-105
 PLUG: TP-07

[STYLE -06]

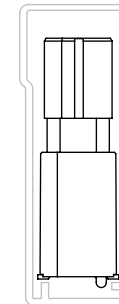

TUBE: PT-1-24-01-105
 PLUG: TP-26

PACKAGING VIEW
 (PARTS TO HAVE POSITION #01 LOADED IN SAME DIRECTION AS ARROW)

F:\DWG\MISC\MKTG\BTH-XXX-XX-X-D-XX-MKT.SLDDRW

PROPRIETARY NOTE
 THIS DOCUMENT CONTAINS CONFIDENTIAL AND PROPRIETARY INFORMATION AND ALL DESIGN, MANUFACTURING, REPRODUCTION, USE, PATENT RIGHTS AND SALES RIGHTS ARE EXPRESSLY RESERVED BY SAMTEC, INC. THIS DOCUMENT SHALL NOT BE DISCLOSED, IN WHOLE OR PART, TO ANY UNAUTHORIZED PERSON OR ENTITY NOR REPRODUCED, TRANSFERRED OR INCORPORATED IN ANY OTHER PROJECT IN ANY MANNER WITHOUT THE EXPRESS WRITTEN CONSENT OF SAMTEC, INC.

DO NOT SCALE DRAWING

SHEET SCALE: 1.875:1



520 PARK EAST BLVD, NEW ALBANY, IN 47150
 PHONE: 812-944-6733 FAX: 812-948-5047
 e-Mail: info@SAMTEC.com code: 55322

DESCRIPTION:
 .5mm DOUBLE ROW TERMINAL ASSEMBLY

DWG. NO.
BTH-XXX-XX-X-D-XX

BY: DEAN P 5/28/1999 SHEET 2 OF 3

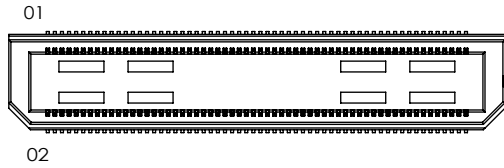

TABLE 4							
STYLE	SEE FIGURE	"C" OVERALL HEIGHT	TERMINAL	TOP BODY (SEE NOTE 4)	BOTTOM SPACER BODY (-LC OR NONE)	BOTTOM SPACER BODY (-A)	MATED HEIGHT WITH BSH-01
-03	3	.4042 [10.267]	T-1S60-03-X	BTH-XXX-02-D	BTHH-XXX-01-D	BTHH-XXX-01-D-A	.433 [11.00] REF
-04	3	.6000 [15.240]	T-1S60-04-X	BTH-XXX-02-D	BTHH-XXX-01-D	BTHH-XXX-01-D-A	.630 [16.00] REF
-05	4	.7180 [18.237]	T-1S60-05-X	BTH-XXX-02-D	BTHH-XXX-03-D	BTHH-XXX-03-D-A	.748 [19.00] REF
-06	4	.8360 [21.234]	T-1S60-06-X	BTH-XXX-02-D	BTHH-XXX-03-D	BTHH-XXX-03-D-A	.866 [22.00] REF
-09	3	.5224 [13.269]	T-1S60-09-X	BTH-XXX-02-D	BTHH-XXX-01-D	BTHH-XXX-01-D-A	.551 [14.00] REF

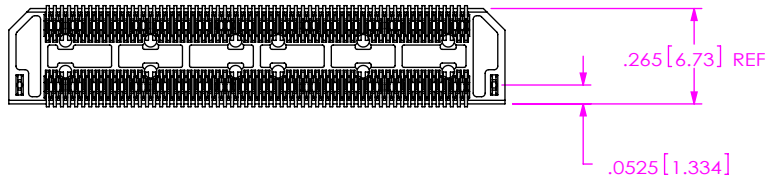
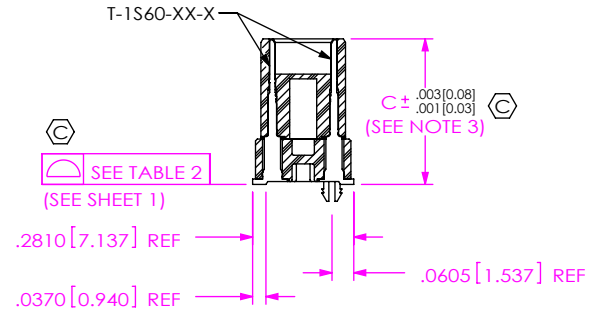
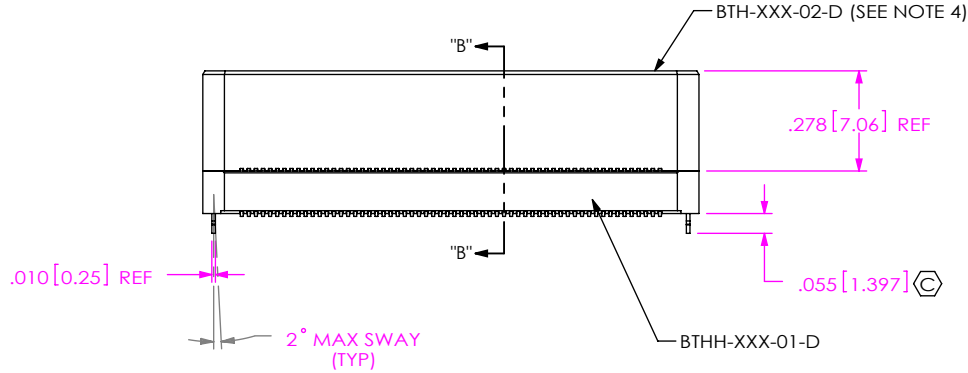

FIG 3
BTH-060-03-X-D-LC SHOWN
(STYLES -03, -04, & -09)
(DIFFERENT AS SHOWN, OTHERWISE SAME AS FIG 1)

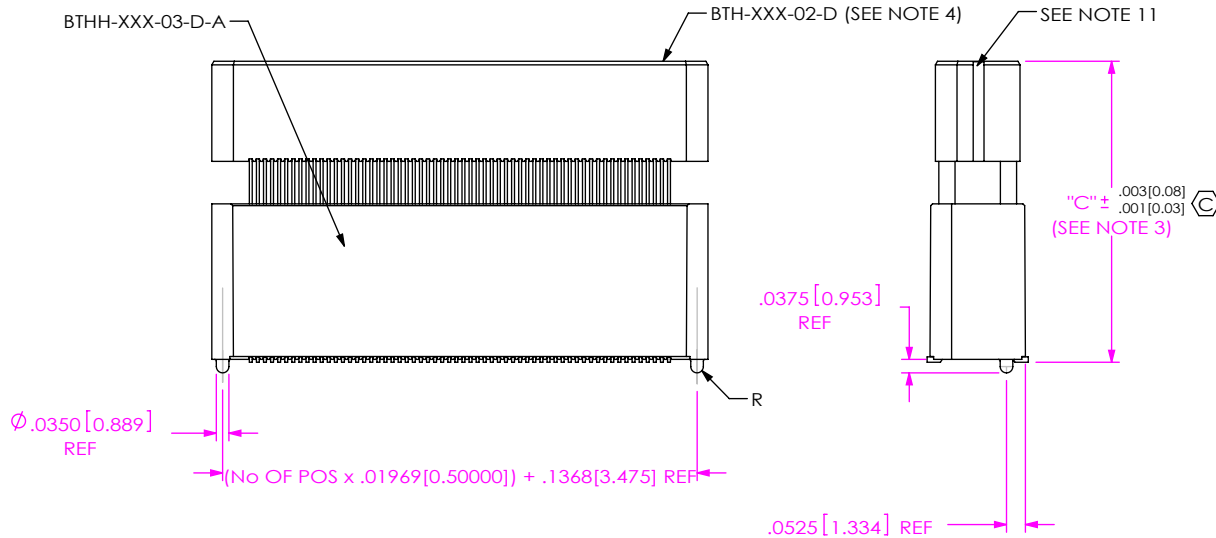



FIG 4
-A: ALIGNMENT PIN OPTION
BTH-060-06-X-D-A SHOWN
[STYLES -05 & -06]
(DIFFERENT AS SHOWN, OTHERWISE SAME AS FIG 1)

PROPRIETARY NOTE
THIS DOCUMENT CONTAINS CONFIDENTIAL AND PROPRIETARY INFORMATION AND ALL DESIGN, MANUFACTURING, REPRODUCTION, USE, PATENT RIGHTS AND SALES RIGHTS ARE EXPRESSLY RESERVED BY SAMTEC, INC. THIS DOCUMENT SHALL NOT BE DISCLOSED, IN WHOLE OR PART, TO ANY UNAUTHORIZED PERSON OR ENTITY NOR REPRODUCED, TRANSFERRED OR INCORPORATED IN ANY OTHER PROJECT IN ANY MANNER WITHOUT THE EXPRESS WRITTEN CONSENT OF SAMTEC, INC.

DO NOT SCALE DRAWING
SHEET SCALE: 1:0.533333

F:\DWG\MISC\MKTG\BTH-XXX-XX-X-D-XX-MKT.SLDDRW



520 PARK EAST BLVD, NEW ALBANY, IN 47150
PHONE: 812-944-6733 FAX: 812-948-5047
e-Mail: info@SAMTEC.com code: 55322

DESCRIPTION:
.5mm DOUBLE ROW TERMINAL ASSEMBLY

DWG. NO.
BTH-XXX-XX-X-D-XX

BY: DEAN P 5/28/1999 SHEET 3 OF 3