

Coaxial

Adapter *2.92mm-F to 2.92mm-M*

KF-KM50+

50Ω DC to 40 GHz

The Big Deal

- Ultra-wideband, DC-40 GHz
- Flat response
- Low insertion loss, 0.09 dB
- Excellent VSWR, 1.04:1



CASE STYLE: DJ1861

Product Overview

Mini-Circuits' KF-KM50+ is a coaxial 2.92mm-F to 2.92mm-M adapter supporting a wide range of applications from DC to 40 GHz. This model provides excellent VSWR, low insertion loss, and flat response versus frequency. The KF-KM50+ features rugged, passivated stainless steel construction and measures only 0.77" (l) x 0.36" (dia.).

Key Features

| Feature | Advantages |
|--|---|
| Wideband, DC to 40 GHz | Wide frequency range provides application flexibility and makes this model ideal for broadband and multi-band use. |
| Excellent VSWR, 1.04:1 | Provides good matching for 50Ω systems and minimizes signal reflections across wide frequency range. |
| Low insertion loss, 0.09 dB | Provides excellent signal power transmission from input to output. |
| Rugged, passivated stainless steel construction. | Stands up to wear and tear in demanding environments and provides excellent reliability. |
| Very wide operating temperature range, -55 to +100°C | Withstands extreme operating conditions and is suitable for use near high power components where heat rise is common. |

Notes

- A. Performance and quality attributes and conditions not expressly stated in this specification document are intended to be excluded and do not form a part of this specification document.
B. Electrical specifications and performance data contained in this specification document are based on Mini-Circuit's applicable established test performance criteria and measurement instructions.
C. The parts covered by this specification document are subject to Mini-Circuits standard limited warranty and terms and conditions (collectively, "Standard Terms"); Purchasers of this part are entitled to the rights and benefits contained therein. For a full statement of the Standard Terms and the exclusive rights and remedies thereunder, please visit Mini-Circuits' website at www.minicircuits.com/MCLStore/terms.jsp



Coaxial Adapter *2.92mm-F to 2.92mm-M*

KF-KM50+

50Ω DC to 40 GHz

Maximum Ratings

| | |
|-----------------------|----------------|
| Operating Temperature | -55°C to 100°C |
| Storage Temperature | -55°C to 100°C |

Permanent damage may occur if any of these limits are exceeded.



Generic photo used for illustration purposes only

CASE STYLE: DJ1861

| Connectors | Model |
|---------------|----------|
| 2.92mm-Female | KF-KM50+ |
| 2.92mm-Male | |

+RoHS Compliant

The +Suffix identifies RoHS Compliance. See our web site for RoHS Compliance methodologies and qualifications

Features

- flat response
- excellent VSWR, 1.03 typ. up to 18 GHz and 1.04 typ. up to 40 GHz
- low cost adapters, available from stock
- rugged stainless steel body, passivated
- qualified to 500 mating cycles
- 2.92mm connectors mates with SMA,3.5mm connectors

Applications

- interconnection of RF cable and equipment

Electrical Specifications at 25°C

| Parameter | Condition (GHz) | Min. | Typ. | Max. | Units |
|-----------------|-----------------|------|------|------|-------|
| Frequency Range | | DC | | 40 | GHz |
| Insertion Loss | DC - 40 | — | 0.09 | — | dB |
| VSWR | DC - 18 | — | 1.03 | 1.15 | :1 |
| | DC - 26 | — | 1.04 | 1.15 | |
| | DC - 40 | — | 1.04 | 1.15 | |

Outline Drawing

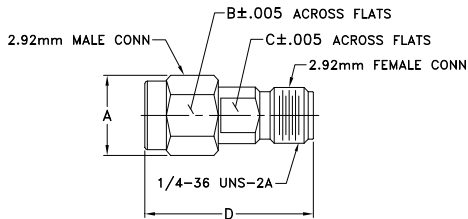

Outline Dimensions (inch/mm)

| A | B | C | D | E | wt |
|------|-------|-------|-------|----|-------|
| 0.36 | 0.312 | 0.234 | 0.77 | -- | grams |
| 9.14 | 7.93 | 5.95 | 19.50 | -- | 3.8 |

Typical Performance Data

| Frequency (GHz) | Insertion Loss (dB) | VSWR (:1) | |
|-----------------|---------------------|-----------|-----------|
| | | 2.92 mm-F | 2.92 mm-M |
| 0.05 | 0.02 | 1.04 | 1.04 |
| 0.10 | 0.03 | 1.02 | 1.02 |
| 0.50 | 0.05 | 1.02 | 1.02 |
| 1.00 | 0.06 | 1.02 | 1.02 |
| 2.00 | 0.07 | 1.02 | 1.03 |
| 5.00 | 0.09 | 1.03 | 1.04 |
| 10.00 | 0.11 | 1.01 | 1.03 |
| 15.00 | 0.10 | 1.04 | 1.04 |
| 18.00 | 0.10 | 1.05 | 1.07 |
| 20.00 | 0.10 | 1.06 | 1.09 |
| 22.00 | 0.10 | 1.05 | 1.10 |
| 24.00 | 0.10 | 1.04 | 1.08 |
| 26.00 | 0.10 | 1.05 | 1.05 |
| 28.00 | 0.10 | 1.05 | 1.03 |
| 30.00 | 0.11 | 1.04 | 1.01 |
| 32.00 | 0.11 | 1.02 | 1.02 |
| 34.00 | 0.12 | 1.02 | 1.05 |
| 36.00 | 0.12 | 1.03 | 1.07 |
| 38.00 | 0.12 | 1.03 | 1.06 |
| 40.00 | 0.12 | 1.02 | 1.06 |

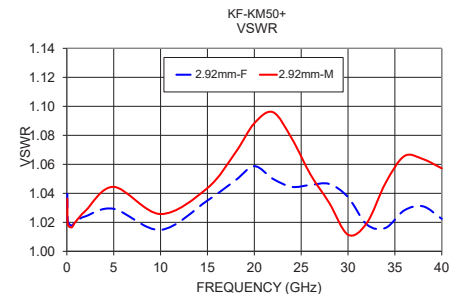
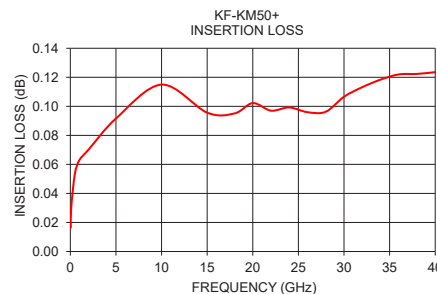

Notes

- Performance and quality attributes and conditions not expressly stated in this specification document are intended to be excluded and do not form a part of this specification document.
- Electrical specifications and performance data contained in this specification document are based on Mini-Circuit's applicable established test performance criteria and measurement instructions.
- The parts covered by this specification document are subject to Mini-Circuits standard limited warranty and terms and conditions (collectively, "Standard Terms"); Purchasers of this part are entitled to the rights and benefits contained therein. For a full statement of the Standard Terms and the exclusive rights and remedies thereunder, please visit Mini-Circuits' website at www.minicircuits.com/WCLStore/terms.jsp

