

IP67

03

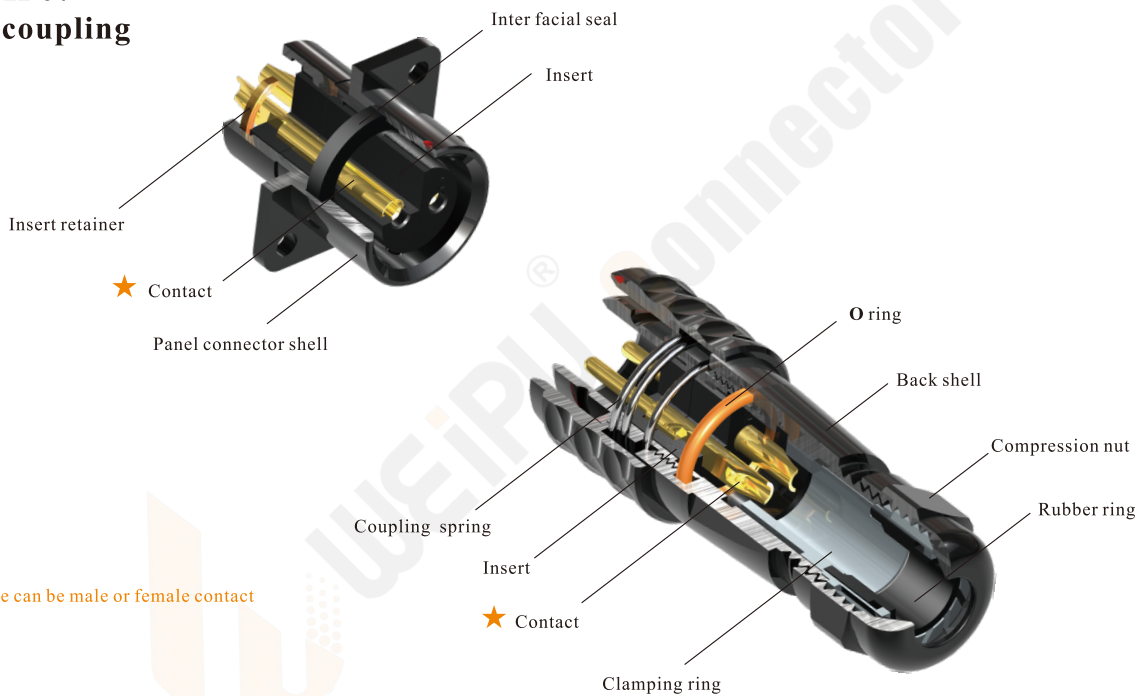

- SA Series IP67
- Push-pull coupling



★ Each side can be male or female contact

Material and spec

Coupling	Push-pull
Shell material	Anodized aluminium
Insert material	PPS, max temperature 260 °C
Contact material	Brass with gold plating
Termination	Solder: SA6, SA8, SA10, SA12, SA16, SA20, SA24, SA28 Crimp: SA16, SA20, SA24, SA28 Screw: SA20, SA24, SA28
Cable outer diameter range	SA6: I:2-3mm, II:3-4mm SA12: I: 4-6.5mm , II: 5-8mm SA24:10-14mm SA8: I:3-4mm, II: 4-5mm SA16: I: 5-8mm , II: 8-12mm SA28:I:9-13mm, II :13-16mm SA10:I:3-4mm, II:4-6.5mm SA20: I: 5-9mm, II: 8-12mm
IP rating	IP67
Mating cycle	500, USB:1000
Temperature range	-40°C ~ +85°C; SA24 Data: -20°C ~ +70°C
Insulation resistance	2000 MΩ

SA12 Series

**SA
12**

03



Cable connector
Mate with SA1211, SA1212
SA1213, SA1215

SA1210/P — SA1210/S

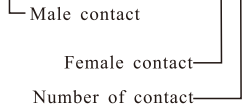

Colour:
B: Black
S: Silver
L: Blue (special order)
G: Green (special order)
R: Red (special order)

Cable outer diameter
I : 4-6.5mm, II : 5-8mm

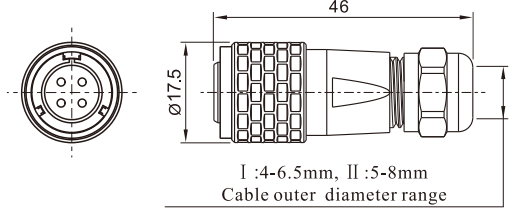

In-line cable connector
Mate with SA1210

SA1211/P — SA1211/S

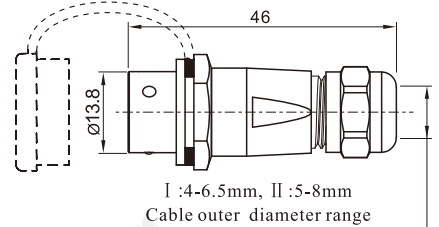
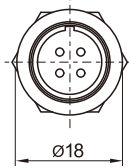

Rear-nut mount
Mate with SA1210

SA1212/P — SA1212/S

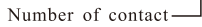

Colour:
B: Black
S: Silver
L: Blue (special order)
G: Green (special order)
R: Red (special order)

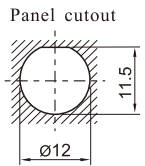
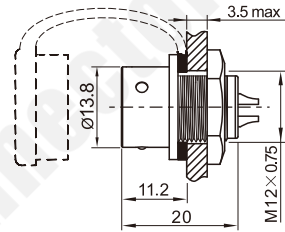
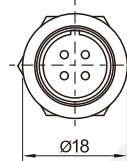

Square flange
Mate with SA1210

SA1213/P — SA1213/S

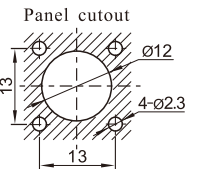
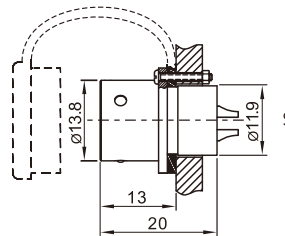
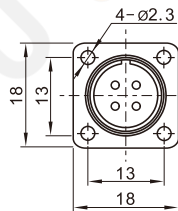

Front-nut mount
Mate with SA1210

SA1215/P — SA1215/S

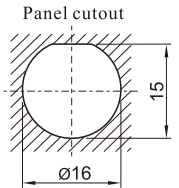
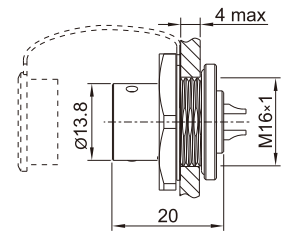
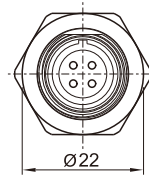

Solder contact spec

Number of contact	2	3	4	5	6	7	9
Male contact face view							
Rated current (A)	13	13	5	5	5	5	3
Contact diameter	Ø1.6X2	Ø1.6X3	Ø1X4	Ø1X5	Ø1X6	Ø1X7	Ø0.7X9
Rated voltage (AC.V)	250	250	200	180	125	125	125
Test voltage(AC.V) 1 min	1500	1500	1500	1000	1000	1000	1000
Contact resistance (mΩ)	2.5	2.5	5	5	5	5	10
Wire size (mm ² /AWG)	≤2/14	≤2/14	≤0.75/18	≤0.75/18	≤0.75/18	≤0.75/18	≤0.5/20