

RECOMMENDED P.C. BOARD HOLE PATTERN FOR STRAIGHT PINS

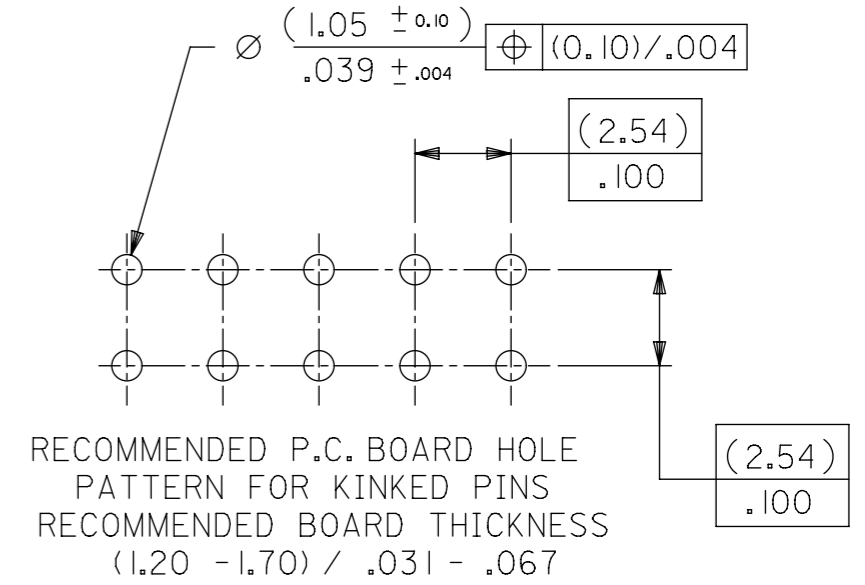

RECOMMENDED P.C. BOARD HOLE PATTERN FOR KINKED PINS
RECOMMENDED BOARD THICKNESS (1.20 - 1.70) / .031 - .067

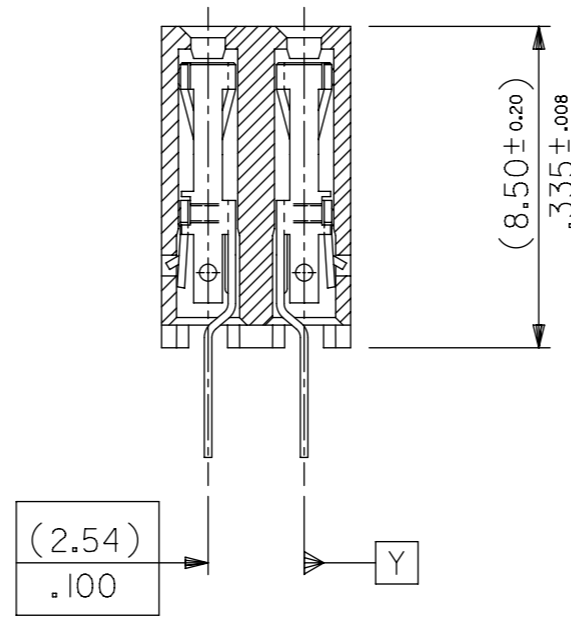

SECTION C-C

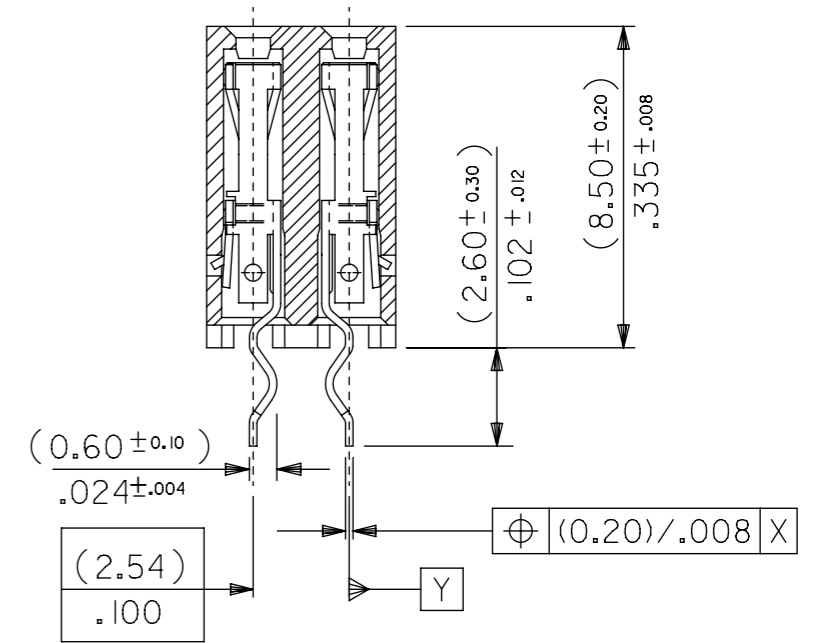

SECTION C-C

NOTES

- 1) CONTACT-PLATED PHOSPHOR BRONZE.
- 2) HOUSING-15% GLASS FILLED POLYESTER. COLOUR-BLACK.
- 3) COMPATIBLE WITH PCB HOLE PATTERN.
- 4) FOR (0.635)/.025 SQ. MALE PINS THE LENGTH MUST BE (5.65)/.222 MIN & (7.00)/.276 MAX. TO ENSURE GOOD CONNECTION WITH CONTACT.

6	AF
5	AD
4	AD
3	AD
2	AG
1	AH

THIS DRAWING CONTAINS INFORMATION THAT IS PROPRIETARY TO MOLEX ELECTRONIC TECHNOLOGIES, LLC AND SHOULD NOT BE USED WITHOUT WRITTEN PERMISSION									
DIMENSION UNITS		SCALE		CURRENT REV DESC: MIGRATED				molex	
mm		1:1							
GENERAL TOLERANCES (UNLESS SPECIFIED)				EC NO: 615440		C-GRID III DUAL ROW VERTICAL P.C. BOARD CONNECTOR			
4 PLACES ±		MM		DRWN: MKP		2019/04/10		PRODUCT CUSTOMER DRAWING	
3 PLACES ±		INCH		CHK'D: NMANE02		2019/04/12			
2 PLACES ±		0.05 ±		APPR: MRAMAKRISHNA		2019/04/12			
1 PLACE ±		0.1 ±		INITIAL REVISION:					
0 PLACES ±				DRWN: DB		21/07/86		DOCUMENT NUMBER	
ANGULAR TOL ± °				APPR:				SDA-90151	
DRAFT WHERE APPLICABLE MUST REMAIN WITHIN DIMENSIONS				THIRD ANGLE PROJECTION		DRAWING		MATERIAL NUMBER	
				A3-SIZE		SERIES		CUSTOMER	
				90151		SEE TABLE		GENERAL MARKET	
						SHEET NUMBER		1 OF 6	

10
PART NO. SEE CHART
SDA-90151
DWG. NO.

PART NO. STRAIGHT PINS	PART NO. KINKED PINS	NO. OF CKTS.	DIM." A"	DIM." B" (^{+0.00} / _{-0.30}) ^{+0.000} / _{-.012}	QTY. PER TUBE
90151-2X04	90151-3X04	4	(2.54) .100	(5.08) .200	105
↑ ↑ 06	↑ ↑ 06	6	(5.08) .200	(7.62) .300	72
↑ ↑ 08	↑ ↑ 08	8	(7.62) .300	(10.16) .400	52
↑ ↑ 10	↑ ↑ 10	10	(10.16) .400	(12.70) .500	44
↑ ↑ 12	↑ ↑ 12	12	(12.70) .500	(15.24) .600	36
↑ ↑ 14	↑ ↑ 14	14	(15.24) .600	(17.78) .700	30
↑ ↑ 16	↑ ↑ 16	16	(17.78) .700	(20.32) .800	26
↑ ↑ 18	↑ ↑ 18	18	(20.32) .800	(22.86) .900	24
↑ ↑ 20	↑ ↑ 20	20	(22.86) .900	(25.40) 1.000	22
↑ ↑ 22	↑ ↑ 22	22	(25.40) 1.000	(27.94) 1.100	20
↑ ↑ 24	↑ ↑ 24	24	(27.94) 1.100	(30.48) 1.200	18
↑ ↑ 26	↑ ↑ 26	26	(30.48) 1.200	(33.02) 1.300	16
↑ ↑ 28	↑ ↑ 28	28	(33.02) 1.300	(35.56) 1.400	14
↑ ↑ 30	↑ ↑ 30	30	(35.56) 1.400	(38.10) 1.500	14
↑ ↑ 32	↑ ↑ 32	32	(38.10) 1.500	(40.64) 1.600	13
↑ ↑ 34	↑ ↑ 34	34	(40.64) 1.600	(43.18) 1.700	12
↑ ↑ 36	↑ ↑ 36	36	(43.18) 1.700	(45.72) 1.800	12
↑ ↑ 38	↑ ↑ 38	38	(45.72) 1.800	(48.26) 1.900	11
↑ ↑ 40	↑ ↑ 40	40	(48.26) 1.900	(50.80) 2.000	11
↑ ↑ 42	↑ ↑ 42	42	(50.80) 2.000	(53.34) 2.100	11
↑ ↑ 44	↑ ↑ 44	44	(53.34) 2.100	(55.88) 2.200	10
↑ ↑ 46	↑ ↑ 46	46	(55.88) 2.200	(58.42) 2.300	10
↑ ↑ 48	↑ ↑ 48	48	(58.42) 2.300	(60.96) 2.400	9
↑ ↑ 50	↑ ↑ 50	50	(60.96) 2.400	(63.50) 2.500	8
↑ ↑ 52	↑ ↑ 52	52	(63.50) 2.500	(66.04) 2.600	8
↑ ↑ 54	↑ ↑ 54	54	(66.04) 2.600	(68.58) 2.700	8
↑ ↑ 56	↑ ↑ 56	56	(68.58) 2.700	(71.12) 2.800	7
↑ ↑ 58	↑ ↑ 58	58	(71.12) 2.800	(73.66) 2.900	7
↑ ↑ 60	↑ ↑ 60	60	(73.66) 2.900	(76.20) 3.000	7
↓ ↓ 62	↓ ↓ 62	62	(76.20) 3.000	(78.74) 3.100	7
90151-2X64	90151-3X64	64	(78.74) 3.100	(81.28) 3.200	6

PLATING VERSION A

PRE-PLATED HOT DIP TIN
1.0 TO 2.5 um (.000040" TO .000100").

PLATING VERSION E

1.27 TO 1.78 um (.000050" TO .000070") NICKEL
OVERALL, 0.38 TO 0.64 um (.000015" TO .000025")
GOLD ON CONTACT AREA (OVER NICKEL).
3 TO 5 um (.000120" TO .000200") TIN
ON SOLDER TAILS (OVER NICKEL).

PLATING VERSION F.

1.27 TO 1.78 um (.000050" TO .000070") NICKEL
OVERALL, 0.76 TO 1.0 um (.000030" TO .000040")
GOLD ON CONTACT AREA (OVER NICKEL).
3 TO 5 um (.000120" TO .000200") TIN
ON SOLDER TAILS (OVER NICKEL).

PLATING VERSION G.

1.27 TO 1.78 um (.000050" TO .000070") NICKEL
OVERALL, 0.125 um MIN. (.000005" MIN.) GOLD FLASH
ON CONTACT AREA (OVER NICKEL).
3 TO 5 um (.000120" TO .000200") TIN
ON SOLDER TAILS (OVER NICKEL).

PLATING VERSION N.

1.27 TO 1.78 um (.000050" TO .000070") NICKEL
OVERALL, 0.76 TO 2.6 um (.000030" TO .000100")
GOLD ON CONTACT AREA (OVER NICKEL).
4 um (.000120") MINIMUM TIN
ON SOLDER TAILS (OVER NICKEL).

STANDARD PRODUCTS

90151-XXYY

INDICATES NO. OF CIRCUITS.

PLATING CODE.
1 = VERSION A.
2 = VERSION E.
3 = VERSION F.
4 = VERSION N.
5 = VERSION G.

SEE CHART

THIS DRAWING CONTAINS INFORMATION THAT IS PROPRIETARY TO MOLEX ELECTRONIC TECHNOLOGIES, LLC AND SHOULD NOT BE USED WITHOUT WRITTEN PERMISSION									
DIMENSION UNITS mm		SCALE 1:1		CURRENT REV DESC: MIGRATED				molex	
GENERAL TOLERANCES (UNLESS SPECIFIED)				EC NO: 615440					
4 PLACES ±		MM		INCH		DRWN: MKP 2019/04/10		C-GRID III DUAL ROW VERTICAL P.C. BOARD CONNECTOR	
3 PLACES ±		0.05		±		CHK'D: NMANE02 2019/04/12		PRODUCT CUSTOMER DRAWING	
2 PLACES ±		0.1		±		APPR: MRAMAKRISHNA 2019/04/12		DOCUMENT NUMBER	
1 PLACE ±		0.1		±		INITIAL REVISION:		SDA-90151	
0 PLACES ±		ANGULAR TOL ± °		THIRD ANGLE PROJECTION		DRAWING		DOC TYPE	
DRAFT WHERE APPLICABLE MUST REMAIN WITHIN DIMENSIONS		THIRD ANGLE PROJECTION		DRAWING		SERIES		DOC PART	
		THIRD ANGLE PROJECTION		DRAWING		SERIES		REVISION	
		THIRD ANGLE PROJECTION		DRAWING		SERIES		AJ	
		THIRD ANGLE PROJECTION		DRAWING		SERIES		SHEET NUMBER	
		THIRD ANGLE PROJECTION		DRAWING		SERIES		2 OF 6	

SEE CHART
SDA-90151

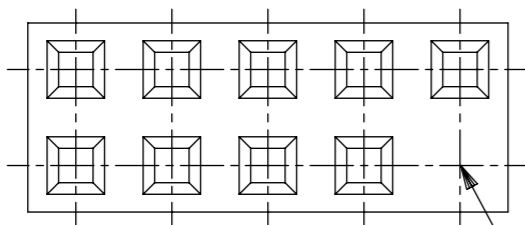

90151-XXYY
INDICATES NO. OF CIRCUITS.
PLATING CODE.
41 = VERSION A.
42 = VERSION E.
43 = VERSION N.
44 = VERSION F.

TYPICAL POSITION VOID

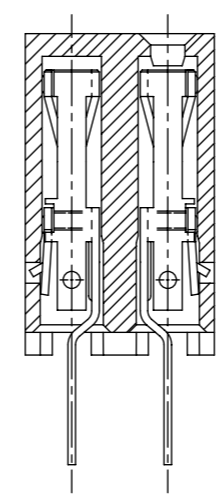
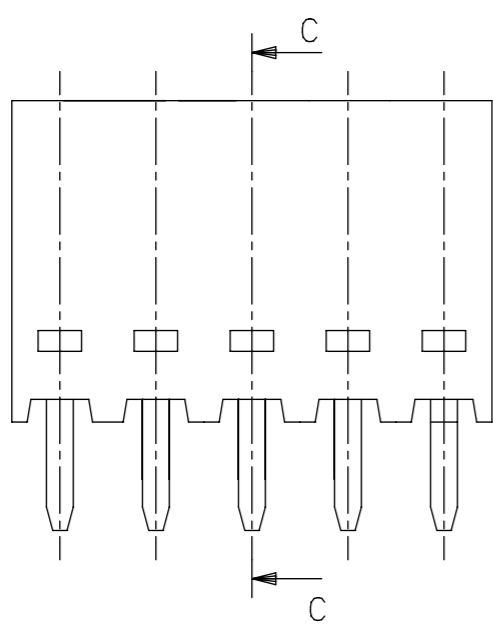

SECTION C-C

PART NUMBER	CKT. SIZE	PIN VOID	QTY. PER TUBE
90151-4424	2 X 12	5	36
90151-4114	2 X 7	1,13.	55
90151-4340	2 X 20	2,4,6,8,12,13,15,16,23 24,26,27,28,30,33, 34,35,36,37,38,40.	11
90151-4322	2 X 11	1,4,5,6,7,8,9,10,11,14 15,16,17,18,19,20,21.	20
90151-4206	2 X 3	3,4	72
90151-4420	2 X 10	1	22

NOTES

- 1) FOR DIMENSIONS SEE SHEET 1.
- 2) FOR PLATING CODE DEFINITIONS SEE SHEET 2.

NON-STANDARD PRODUCTS

THIS DRAWING CONTAINS INFORMATION THAT IS PROPRIETARY TO MOLEX ELECTRONIC TECHNOLOGIES, LLC AND SHOULD NOT BE USED WITHOUT WRITTEN PERMISSION									
DIMENSION UNITS mm		SCALE 1:1		CURRENT REV DESC: MIGRATED				molex	
GENERAL TOLERANCES (UNLESS SPECIFIED)				EC NO: 615440					
				DRWN: MKP		2019/04/10		C-GRID III DUAL ROW VERTICAL P.C. BOARD CONNECTOR	
4 PLACES ±		±		CHK'D: NMANE02		2019/04/12		PRODUCT CUSTOMER DRAWING	
3 PLACES ±		±		APPR: MRAMAKRISHNA		2019/04/12		DOCUMENT NUMBER	
2 PLACES ±		0.05 ±		INITIAL REVISION:				SDA-90151	
1 PLACE ±		0.1 ±		DRWN: DB		21/07/86		DOC TYPE	
0 PLACES ±		±		APPR:				PSD	
ANGULAR TOL ± °		± °		DRAFT WHERE APPLICABLE MUST REMAIN WITHIN DIMENSIONS		THIRD ANGLE PROJECTION		DOC PART	
				DRAWING		SERIES		REVISION	
				A3-SIZE		90151		AJ	
				MATERIAL NUMBER		CUSTOMER		SHEET NUMBER	
				SEE TABLE		GENERAL MARKET		3 OF 6	

PART NO. SEE CHART
 DWG. NO. SDA-90151

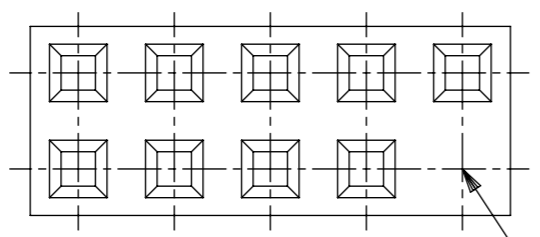

TYPICAL VOID SHOWN

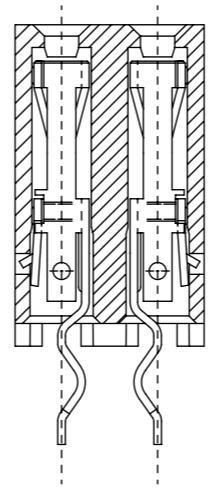
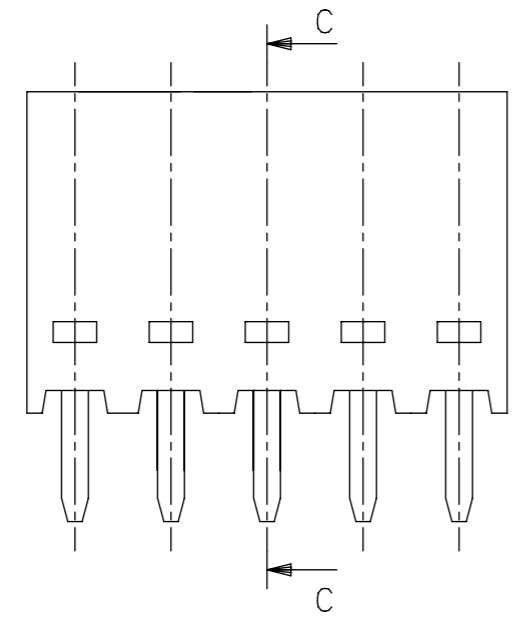

SECTION C-C

PART NO.	CKT SIZE	CONTACT VOIDS	MOULDING COLOUR	PLATING TYPE	QTY. PER TUBE
90151-9216	2 X 8	1, 2, 15, 16	WHITE	E	26

NOTES

1) FOR ALL UNSTATED NOTES AND DIMENSIONS SEE SHEET 1.

NON STANDARD PRODUCTS

THIS DRAWING CONTAINS INFORMATION THAT IS PROPRIETARY TO MOLEX ELECTRONIC TECHNOLOGIES, LLC AND SHOULD NOT BE USED WITHOUT WRITTEN PERMISSION											
DIMENSION UNITS		SCALE		CURRENT REV DESC: MIGRATED				molex			
mm		1:1									
GENERAL TOLERANCES (UNLESS SPECIFIED)				EC NO: 615440				C-GRID III DUAL ROW VERTICAL P.C. BOARD CONNECTOR			
		MM	INCH	DRWN: MKP 2019/04/10							
4 PLACES		±	±	CHK'D: NMANE02 2019/04/12				PRODUCT CUSTOMER DRAWING			
3 PLACES		±	±	APPR: MRAMAKRISHNA 2019/04/12							
2 PLACES		±	0.05	INITIAL REVISION:				DOCUMENT NUMBER SDA-90151			
1 PLACE		±	0.1	DRWN: DB 21/07/86						DOC TYPE	DOC PART
0 PLACES		±	±	APPR:				PSD	001	AJ	
ANGULAR TOL		±	°	DRAFT WHERE APPLICABLE MUST REMAIN WITHIN DIMENSIONS		THIRD ANGLE PROJECTION	DRAWING	SERIES	MATERIAL NUMBER	CUSTOMER	SHEET NUMBER
							A3-SIZE	90151	SEE TABLE	GENERAL MARKET	4 OF 6

PART NO. SEE CHART
 DWG. NO. SDA-90151

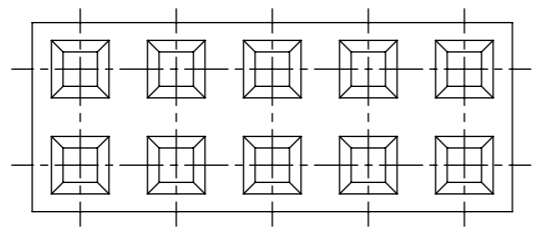

PART NO.	CKT SIZE	CONTACT VOID POSITIONS	MOULDING COLOUR	PLATING TYPE	QTY. PER TUBE
90151-8164	2 X32	1, 2, 63, 64	BLACK	E	12
90151-8138	2 X19	1, 2, 37, 38	BLACK	E	22
90151-8124	2 X12	1, 2, 23, 24	BLACK	E	18
90151-8114	2 X 7	1, 2, 13, 14	BLACK	E	73

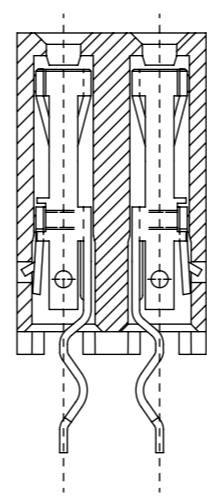
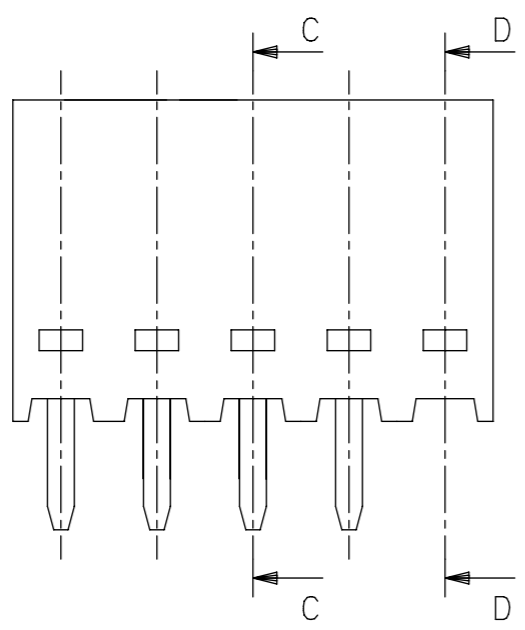

SECTION C-C
 (LOADED CONTACTS)

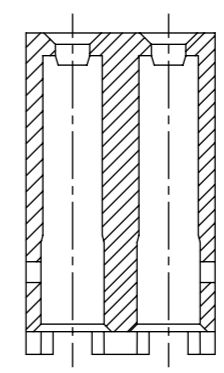

SECTION D-D
 (CONTACTS REMOVED FOR VOID POSITIONS)

NOTES

1) FOR ALL UNSTATED NOTES AND DIMENSIONS SEE SHEET 1.

NON STANDARD PRODUCTS

THIS DRAWING CONTAINS INFORMATION THAT IS PROPRIETARY TO MOLEX ELECTRONIC TECHNOLOGIES, LLC AND SHOULD NOT BE USED WITHOUT WRITTEN PERMISSION											
DIMENSION UNITS		SCALE		CURRENT REV DESC: MIGRATED						molex	
mm		1:1									
GENERAL TOLERANCES (UNLESS SPECIFIED)				EC NO: 615440		2019/04/10		C-GRID III DUAL ROW VERTICAL P.C. BOARD CONNECTOR			
				DRWN: MKP		2019/04/12					
				CHK'D: NMANE02		2019/04/12		PRODUCT CUSTOMER DRAWING			
				APPR: MRAMAKRISHNA		2019/04/12					
				INITIAL REVISION:				DOCUMENT NUMBER: SDA-90151			
				DRWN: DB 21/07/86							
				APPR:				DOC TYPE: PSD		DOC PART: 001	
								REVISION: AJ			
DRAFT WHERE APPLICABLE MUST REMAIN WITHIN DIMENSIONS				THIRD ANGLE PROJECTION		DRAWING: A3-SIZE		SERIES: 90151		MATERIAL NUMBER: SEE TABLE	
								CUSTOMER: GENERAL MARKET		SHEET NUMBER: 5 OF 6	

PART NO. SEE CHART
 DWG. NO. SDA-90151

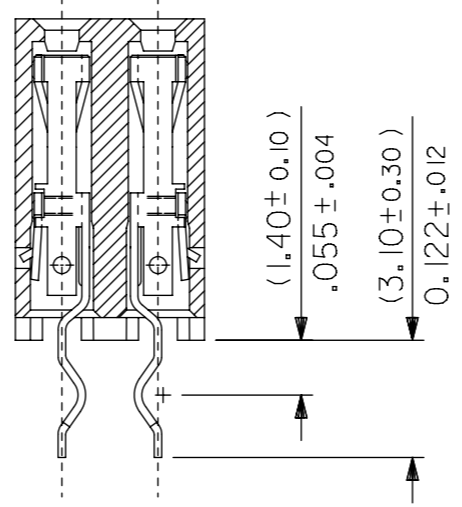
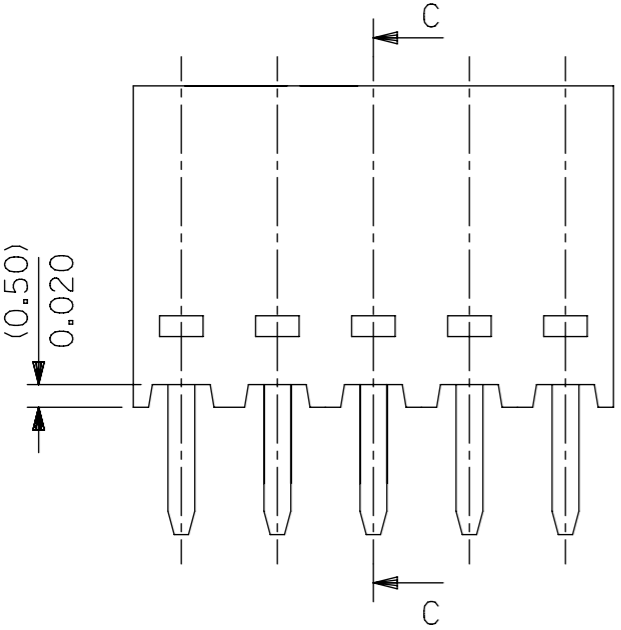
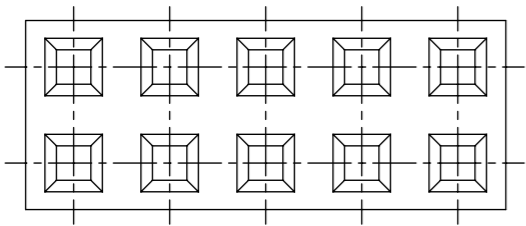

SECTION C-C

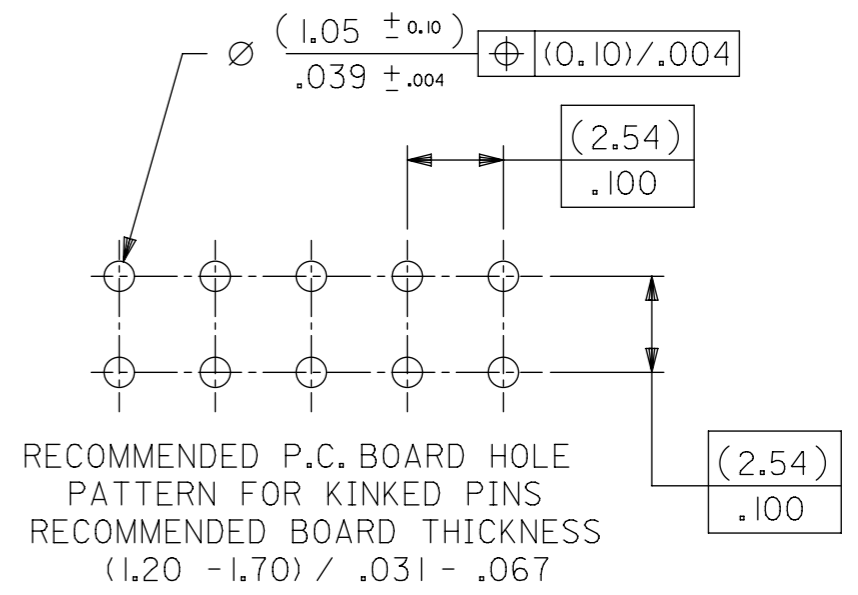

PART No.	CKT SIZE	MOULDING COLOUR	QUANTITY PER TUBE	PLATING VERSION
90151-5238	38	BLACK	11	E

NOTES
 1) FOR ALL UNSTATED NOTES AND DIMENSIONS SEE SHEET 1.

NON STANDARD PRODUCT

THIS DRAWING CONTAINS INFORMATION THAT IS PROPRIETARY TO MOLEX ELECTRONIC TECHNOLOGIES, LLC AND SHOULD NOT BE USED WITHOUT WRITTEN PERMISSION									
DIMENSION UNITS		SCALE		CURRENT REV DESC: MIGRATED				molex	
mm		1:1							
GENERAL TOLERANCES (UNLESS SPECIFIED)				EC NO: 615440		C-GRID III DUAL ROW VERTICAL P.C. BOARD CONNECTOR			
		MM	INCH	DRWN: MKP 2019/04/10		PRODUCT CUSTOMER DRAWING			
4 PLACES ±				CHK'D: NMANE02 2019/04/12		DOCUMENT NUMBER		DOC TYPE	DOC PART
3 PLACES ±				APPR: MRAMAKRISHNA 2019/04/12		SDA-90151		PSD	001
2 PLACES ±		0.05		INITIAL REVISION:		REVISION			
1 PLACE ±		0.1		DRWN: DB 21/07/86		AJ			
0 PLACES ±				APPR:					
ANGULAR TOL ± °				DRAFT WHERE APPLICABLE MUST REMAIN WITHIN DIMENSIONS		THIRD ANGLE PROJECTION	DRAWING	SERIES	MATERIAL NUMBER
				A3-SIZE		90151	SEE TABLE	CUSTOMER	SHEET NUMBER
				GENERAL MARKET		6 OF 6			