

Coaxial

# N-Type Fixed Attenuator

50Ω 1W 3dB DC to 6000 MHz

UNAT-3+



CASE STYLE: FF779

Connectors Model  
N-Type UNAT-3+

**+RoHS Compliant**

The +Suffix identifies RoHS Compliance. See our web site for RoHS Compliance methodologies and qualifications

## Maximum Ratings

Operating Temperature -45°C to 100°C

Storage Temperature -55°C to 100°C

Permanent damage may occur if any of these limits are exceeded.

## Features

- wideband coverage, DC to 6000 MHz
- 1 watt rating
- rugged unibody construction
- off-the-shelf availability
- very low cost

## Applications

- impedance matching
- signal level adjustment

## Outline Drawing

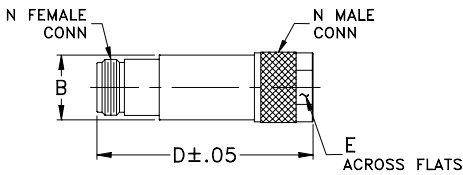

## Outline Dimensions (inch/mm)

|  | B     | D     | E     | wt    |
|--|-------|-------|-------|-------|
|  | .68   | 2.11  | .718  | grams |
|  | 17.27 | 53.59 | 18.24 | 72.5  |

## Electrical Specifications

| FREQ. RANGE (MHz) | ATTENUATION * (dB) |      |      |      |      | VSWR (:1) |      |      |           |      | MAX. INPUT POWER (W) |           |
|-------------------|--------------------|------|------|------|------|-----------|------|------|-----------|------|----------------------|-----------|
|                   | Flatness **        |      |      |      |      | DC-3 GHz  |      |      | 3-4.5 GHz |      |                      | 4.5-6 GHz |
|                   | Nom.               | Typ. | Typ. | Typ. | Typ. | Typ.      | Max. | Typ. | Max.      | Typ. |                      |           |
| DC-6000           | 3±0.3              | 0.20 | 0.10 | 0.10 | 0.35 | 1.05      | 1.20 | 1.22 | 1.43      | 1.50 | 1.0                  |           |

\* Attenuation varies by 0.3 dB max. over temperature.

\*\* Flatness= variation over band divided by 2.

## Typical Performance Data

| Frequency (MHz) | Attenuation (dB) | VSWR (:1) |
|-----------------|------------------|-----------|
| 10              | 2.99             | 1.00      |
| 50              | 3.00             | 1.01      |
| 100             | 3.02             | 1.01      |
| 500             | 3.07             | 1.04      |
| 1000            | 3.11             | 1.06      |
| 1600            | 3.15             | 1.05      |
| 2000            | 3.18             | 1.04      |
| 2500            | 3.21             | 1.03      |
| 3000            | 3.28             | 1.04      |
| 3500            | 3.33             | 1.04      |
| 4000            | 3.34             | 1.06      |
| 4500            | 3.36             | 1.08      |
| 5000            | 3.42             | 1.16      |
| 5500            | 3.47             | 1.33      |
| 6000            | 3.70             | 1.51      |

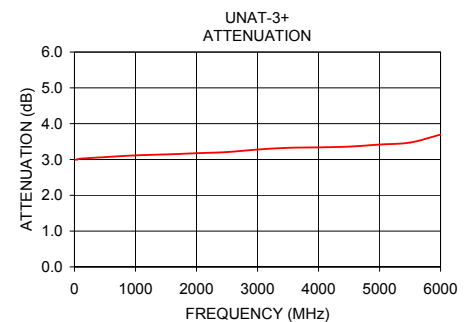
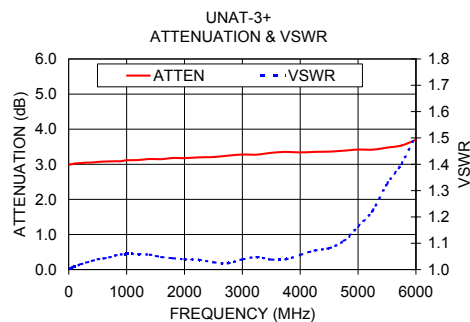

## Notes

- Performance and quality attributes and conditions not expressly stated in this specification document are intended to be excluded and do not form a part of this specification document.
- Electrical specifications and performance data contained in this specification document are based on Mini-Circuit's applicable established test performance criteria and measurement instructions.
- The parts covered by this specification document are subject to Mini-Circuits standard limited warranty and terms and conditions (collectively, "Standard Terms"); Purchasers of this part are entitled to the rights and benefits contained therein. For a full statement of the Standard Terms and the exclusive rights and remedies thereunder, please visit Mini-Circuits' website at [www.minicircuits.com/VCLStore/terms.jsp](http://www.minicircuits.com/VCLStore/terms.jsp)

