

OPERATING INSTRUCTIONS

MOBILITY DOCK

EN



Lapp Mobility GmbH
Oskar-Lapp-Str. 2 · D-70565 Stuttgart
www.lappmobility.com

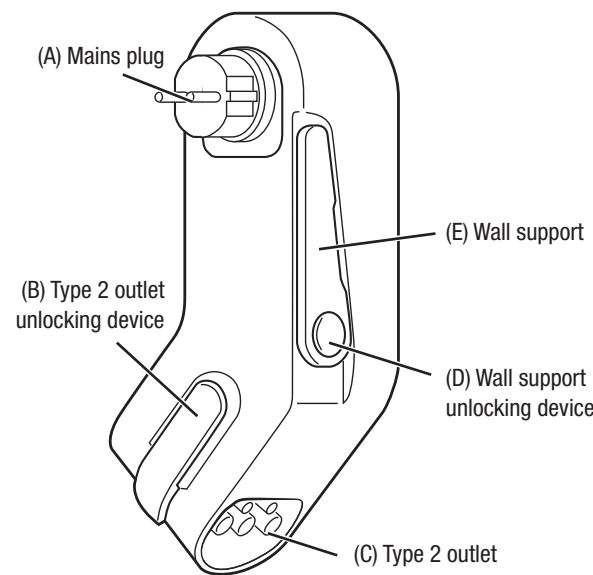

Fig. 1 Product components

SYMBOLS

- Protective conductor not switched
- Not suitable for IT-net
- Minimum ambient temperature
- Do not use just any type of extension cord!
- Do not use Mobility Dock and charging cables that are damaged anywhere on the housing, connector or cable!
- Do not use travel adapters!
- Do not use multiple sockets!
- Do not dispose as unsorted municipal waste
- Do not use Mobility Dock if it is lying on the floor
- Follow the operating instructions
- Type 2 power socket
- WARNING** indicates a danger with a moderate risk of causing death or serious injury if it is not avoided.

IMPORTANT SAFETY INSTRUCTIONS

Read all the instructions before using this product! Save instructions for future reference.

WARNING RISK OF FIRE OR ELECTRIC SHOCK

Insufficient quality of the socket outlet may cause electric shock and/or fire.

- The Mobility Dock may only be operated from a socket suitable for this purpose. The connection must comply with the applicable national norms and standards.
- The Mobility Dock may only be used in properly earthed networks.
- Unsupervised charging is only permitted at an industrial or household socket-outlet that has been checked by an electrician.
- Unsupervised charging at a household socket-outlet that has not been checked by an electrician may lead to a fire inside the house.
- Unauthorized people, particularly children, must not be able to access the charging cable or vehicle during unsupervised charging.

WARNING RISK OF EXPLOSION

The Mobility Dock can generate sparks that can ignite gases and dusts.

- Do not use the Mobility Dock in rooms with an increased risk of explosion.

WARNING RISK OF ELECTRIC SHOCK, SHORT CIRCUIT, FIRE, EXPLOSION

Use of a damaged charging cable, a defective or faulty plug/coupling or a defective or faulty Mobility Dock as well as improper use or failure to observe the safety instructions may result in short circuit, electric shock, burns, explosion or fire.

- Visually check all components for damage. Do not use damaged components!
- Only connect the Mobility Dock to correctly connected, undamaged wall sockets that have been installed and tested by a qualified electrician.
- Check connectors and mobility dock for visible damage (cracks, broken parts) and dirt before use. Do not use cables with damaged plugs or dirty housing.
- Mobility Dock must not be opened. Dangerous voltages can discharge in the housing, which can lead to an electric shock or death.
- No repairs or modifications may be carried out on the Mobility Dock (e.g. replacement of the plug).
- Never immerse the Mobility Dock and accessories in water.

- Keep the Mobility Dock away from sources of dust and chemical emissions (e.g. oil mist, soldering fumes, chemical vapours).
- Do not drop the Mobility Dock.
- Avoid strong bending or twisting of the cable.
- Avoid strong tensile stress on the cable.
- If the plugged-in Mobility Dock or the power socket is damaged: Block the danger zone, switch off the power at the fuse and only then disconnect. Consult a qualified electrician on how to proceed.

WARNING RISK OF FIRE OR ELECTRIC SHOCK

Incorrect use of the Mobility Dock may result in electric shock.

- Do not touch the contacts of the plug connections.
- Do not insert any objects into the plug connections.
- Protect all contacts against moisture.
- Only operate the Mobility Dock vertically suspended and supported on a wall socket to avoid pulling on the wall socket (see fig. 2). Heavy loads can damage the Mobility Dock and/or the power socket.
- Do not plug the Mobility Dock into the socket until the charging plug is engaged in the type 2 outlet (C). Otherwise the wall socket may be damaged.
- Do not use the Mobility Dock for anything other than its intended use (for example, do not use it with power sockets that are near to the ground).

INTENDED USE

The Mobility Dock is a Mode 2 emergency charger for occasional, portable use. Permanent use only in a safe, motionless and vertical position. Operation only on mechanically and electrically suitable, wall-mounted sockets (see fig. 2, step 5)!

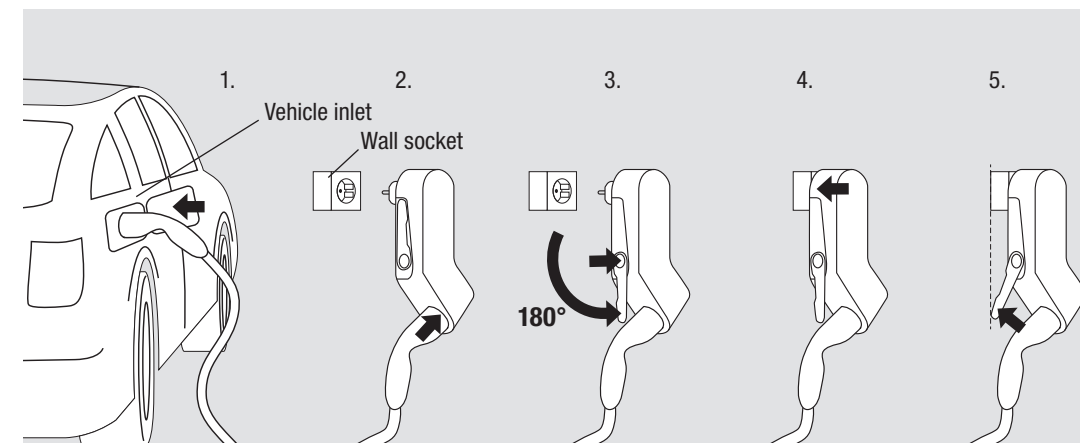

Fig. 2: Charging sequence

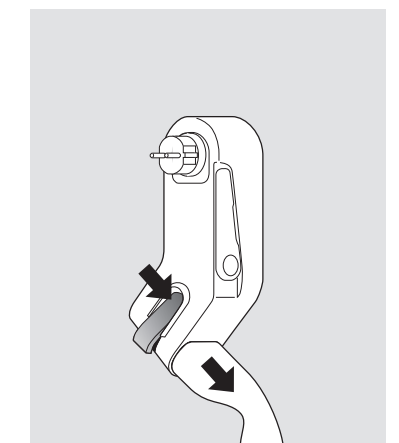

Fig. 3: Unlocking the type 2 outlet

OPERATION

Charging

- Insert the vehicle coupling into the vehicle inlet
 - Insert the charging plug into the type 2 outlet (C) until it clicks into place (B).
 - Unlock the wall support (E) with the knob (D) and fold it out in the direction of the arrow until it stops.
 - Insert the mains plug (A) into a suitable wall socket so that the housing hangs downwards. The Mobility Dock performs a self-test.
 - Turn the wall support until the Mobility Dock is supported in the vertical position.
- WARNING** If the Mobility Dock is not supported, there is a risk of fire due to damage to the socket. Only use Mobility Dock if the wall support is long enough to support it!
- The Mobility Dock communicates with the vehicle and releases the charge.

End charging

- End charging via the vehicle (LED lights up permanently green)
- WARNING** Risk of electric shock and fire. Charging must be completed before unplugging the Mobility Dock!
- Unplug the Mobility Dock (A) from the wall socket
 - Unlock (D) the wall support (E) and bring it into the starting position
 - If necessary, unlock the charging plug with the orange lever (B) and unplug it (see fig. 3)
 - Unplug the vehicle coupling from the vehicle
 - Stow the Mobility Dock and cable securely in the boot (see 'Transport and storage').

STATUS DISPLAY

LED	Light sequence	System status
---	permanently off	not in socket
green	permanently on	Self test OK - Vehicle connected - Standby
green	Flashing	Charging
blue	Flashing	Reduced charging (e.g. at high temperature)
yellow/green	Flashing	Vehicle connected *) WARNING STATUS DISPLAY
yellow	Flashing	Charging *) WARNING STATUS DISPLAY
white	permanently on	Self test OK - Vehicle not connected: Disconnect Mobility Dock from socket and connect to vehicle first
white	Flashing	*) WARNING STATUS DISPLAY Self test OK - Vehicle not connected: Disconnect Mobility Dock from socket and connect to vehicle first
red	permanently on	Temporary error (e.g. after overtemperature): Device restarts automatically
red	Flashing	Safety error (e.g. Mobility Dock installed upside down): Disconnect the unit from the mains for 10 sec., rectify the fault and plug it in again

*) **WARNING STATUS DISPLAY** The Mobility Dock is not suitable for operation on extension leads or for horizontal operation. If the Mobility Dock is lying on the ground, there is a risk of electric shock due to penetration of liquids and housing damage due to being run over!

TECHNICAL DATA

Charging power	2.3 kW
Nominal voltage range	230V AC
Nominal current	10 A *)
Frequency	50 Hz
Residual current circuit breaker (RCD)	30 mA AC 6 mA DC
Protection class	I
Operating temperature	-25 °C to +45 °C
Storage temperature	-40 °C to +85 °C
IP degree of protection	IP44
Can be connected to	CEE 7/3 Typ F

*) Only for France and Finland: if the charging cycle can exceed 2 hours, the max. rated current to be set on the vehicle is 8 A.

TRANSPORT AND STORAGE

WARNING An unsecured, inadequately secured or improperly stored mobility dock can slip when braking or changing direction or injure the occupants in an accident.

- Never transport the Mobility Dock unsecured.
 - Never transport the Mobility Dock in the passenger compartment (e.g. on or in front of the seats)
- Dirt, moisture and damage to the Mobility Dock endanger safe operation. Risk of serious or fatal injury from electric shock or fire.**
- Store the Mobility Dock dry, clean and protected from chemical vapours, e.g. in the boot.
 - Store the Mobility Dock carefully so that its casing and mains plug (A) are protected against damages during transport.

MAINTENANCE AND CARE

Disconnect the Mobility Dock from the vehicle and the mains before cleaning. Clean only with a slightly damp cloth. Do not use aggressive cleaning agents.

DISPOSAL

The crossed-out wheeled bin logo requires the separate collection of waste electric and electronic equipment (WEEE). Such equipment may contain dangerous and hazardous substances. These tools must be returned to a designated collection point for the recycling of WEEE and must not be disposed as unsorted municipal waste. By doing so, you will help to conserve resources and protect the environment. Contact your local authorities for more information.